

Project Logo

CADOGAN
GARDINER & THEOBALD
JOHN MCASLAN + PARTNERS
ANDYSTURGEONDESIGN lapd wsp

Notes

1. Refer to WSP consultants drawings for highway street furniture, visibility splays, parking restrictions, drainage layout and other engineering details.
2. Refer to LAPD consultants drawings for street lighting strategy.
3. Refer to ASD consultants drawings for planting design drawings.
4. Do not scale from this drawing.
5. All dimensions are to be checked on site and any discrepancies noted in writing to the Project Manager.
6. All dimensions are in millimeters unless noted otherwise.

| Rev. | Date | Description | Drawn | Checked |
|------|------------|---------------------------|-------|---------|
| C01 | 14/10/2022 | STAGE 5: FOR CONSTRUCTION | DO | KB |
| C02 | 19/12/2022 | STAGE 5: FOR CONSTRUCTION | DO | KB |
| C03 | 31/03/2023 | STAGE 5: FOR CONSTRUCTION | DO | KB |

KEY

- Site boundary
- Scope delivered outside main works
- Scope awaiting further input
- Early work
- Existing kerb line
- Doors/Steps

| SURFACES | REFER TO |
|---|--|
| P1 - Yorkstone flags Type 1 - 63mm | Plan: DRN-1100 to DRN-1216 Draw: DRN-4002 to DRN-4016 DRN-4017 to DRN-4021 |
| P2 - Yorkstone tiles | Plan: DRN-1100 to DRN-1216 Draw: DRN-4002 |
| P3 - Granite setts | Plan: DRN-1100 to DRN-1216 Draw: DRN-4002 to DRN-4016 DRN-4017 to DRN-4021 |
| P4 - Vehicular grade asphalt | WSP Drawings |
| P5 - Tactile paving | Plan: DRN-1100 to DRN-1216 Draw: DRN-4002 |
| P6 - Granite setts | Plan: DRN-1100 to DRN-1216 Draw: DRN-4002 |
| P7 - Yorkstone flags Type 2 - 25mm | Plan: DRN-1100 to DRN-1216 Draw: DRN-4002 |
| P8 - Luxcrete finish to be retained | Plan: DRN-1100 to DRN-1216 |
| P10 - Resin bound gravel | Plan: DRN-1100 to DRN-1216 Draw: DRN-4002 to DRN-4016 DRN-4017 to DRN-4021 |
| P11a - Yorkstone setts | |
| P11b - Yorkstone setts - tumbled | |
| P12 - Loose gravel | |
| K1 - Granite kerb type 1 | Plan: DRN-1100 to DRN-1216 WSP Drawings to detail |
| K2 - Granite kerb type 2 | Plan: DRN-1100 to DRN-1216 WSP Drawings to detail |
| K3 - Special granite kerbs (sizes vary) | Plan: DRN-1100 to DRN-1216 Draw: DRN-4002 to DRN-4016 DRN-4017 to DRN-4021 |
| Road Markings | WSP Drawings |

| FURNITURE | REFER TO |
|--|--|
| F1 - Granite planter with integrated seating Types 1,2,4,5,6,7,8,9,10 | Plan: DRN-1100 to DRN-1216 Draw: DRN-4002 to DRN-4016 DRN-4017 to DRN-4021 |
| F2 - Granite planter Type 3 | Plan: DRN-1100 to DRN-1216 Draw: DRN-4002 to DRN-4016 DRN-4017 to DRN-4021 |
| F3A and F3B - Retained cabinets | WSP Drawings |
| F4 - Restored telephone box | WSP Drawings |
| F5 - Retained bus shelter | WSP Drawings |
| F6 - Bike stands | Plan: DRN-1100 to DRN-1216 Draw: DRN-4002 |
| F7 - Retained Post box | Plan: DRN-1100 to DRN-1216 Draw: DRN-4002 |
| F8A - Tree pit surround, filled with resin bound gravel - Existing Tree - Setout to be checked on site | Plan: DRN-1100 to DRN-1216 Draw: DRN-4002 |
| F8B - Tree pit surround, filled with loose gravel - Proposed Tree | Plan: DRN-1100 to DRN-1216 Draw: DRN-4002 |
| F9 - Proposed bins | Plan: DRN-1100 to DRN-1216 Draw: DRN-4002 |
| F10 - Drinking fountain (F10a and F10b) | Plan: DRN-1100 to DRN-1216 Draw: DRN-4002 |
| F11 - Existing BT Inlink unit to be reinstated | Plan: DRN-1100 to DRN-1216 Draw: DRN-4002, DRN-4003 |
| F12 - Proposed Pots positioned above Paving | Plan: DRN-1100 to DRN-1216 Draw: DRN-4002, DRN-4003 |
| F13 - Legible London Refurbished & Reinstated | Plan: DRN-1100 to DRN-1216 |
| F14 - Historic Bollards Refurbished & Reinstated | Plan: DRN-1100 to DRN-1216 Draw: DRN-4002 |
| F15 - Bell Bollard - Refurbished & Reinstated | Plan: DRN-1100 to DRN-1216 Draw: DRN-4002 |
| E4A - Demarcation studs - Private/Public Boundary* and Smoke outlets** | Plan: DRN-1100 to DRN-1216 Draw: DRN-4002 |
| E4B - Extent of Smoke Outlets Panels | Plan: DRN-1100 to DRN-1216 Draw: DRN-4002 |
| E4C - Bronze Smoke Vent Plaque | Plan: DRN-1100 to DRN-1216 Draw: DRN-4002 |
| E5 - Coal Hole Lid Refurbished & Reinstated | Plan: DRN-1100 to DRN-1216 Draw: DRN-4002 |
| Proposed road signage | WSP Drawings |
| Proposed hoops | WSP Drawings |
| Access covers / Road gully / Proposed gully / catch pit | WSP Drawings |

| SOFT LANDSCAPE | REFER TO |
|--|--|
| V1 - Ornamental planting and hedges | ASD Drawings |
| T1 - Existing tree | Plan: DRN-1100 to DRN-1216 Draw: DRN-4002 to DRN-4016 DRN-4017 to DRN-4021 |
| T2 - Proposed single stem tree | ASD Drawings |
| T2A - Proposed single stem tree (smaller size) | ASD Drawings |
| T3 - Proposed multi stem tree | ASD Drawings |
| T4 - Proposed multi stem tree | ASD Drawings |
| N1 - Column luminaire | LAPD Drawings Draw: DRN-4011 |
| N2 and N4 - Column luminaire with belisha beacon | LAPD Drawings Draw: DRN-4011 |
| N3 - Existing lighting column to be retained | LAPD Drawings |
| N5 - Traffic light | WSP Drawings |
| S - In-ground luminaire | LAPD Drawings |

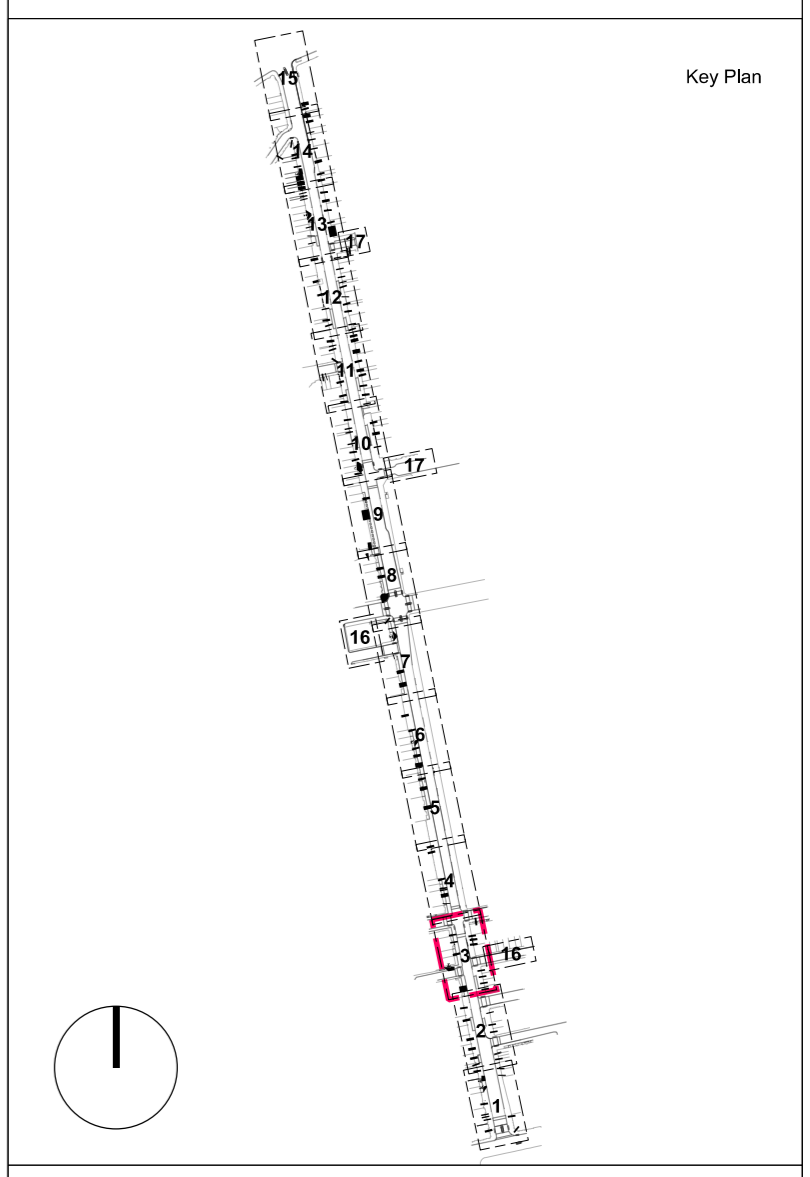

JOHN MCASLAN + PARTNERS
7-9 William Road
London NW1 3ER
T +44 (0)20 7313 6000
F +44 (0)20 7313 6001
www.mcaslan.co.uk

Architect
Landscape

SLOANE STREET PUBLIC REALM
General Arrangement Plan 03

Scale A1:A1: 1:100 @ A1 Job Number: 1491
Date: 25/06/2021 Drawing: DO
Drawing Status: S5 Checked: KB
Drawing Number: 1491-JMP-XX-00-DR-L-3002 Revision: C03